

AMERICAN HYDROTECH, INC.

HYDROTECH
GARDEN
ROOF
ASSEMBLY

NO SCALE

GR-2D

TYP. GARDEN ROOF TERMINATION
PERIMETER PARAPET CONDITION
GARDEN TRAY GT15

REFER TO HYDROTECHS GUIDELINE ROOFING & WATERPROOFING DETAILS
FOR SUGGESTED TERMINATIONS, FLASHING AND MEMBRANE DETAILING SPECIFICS

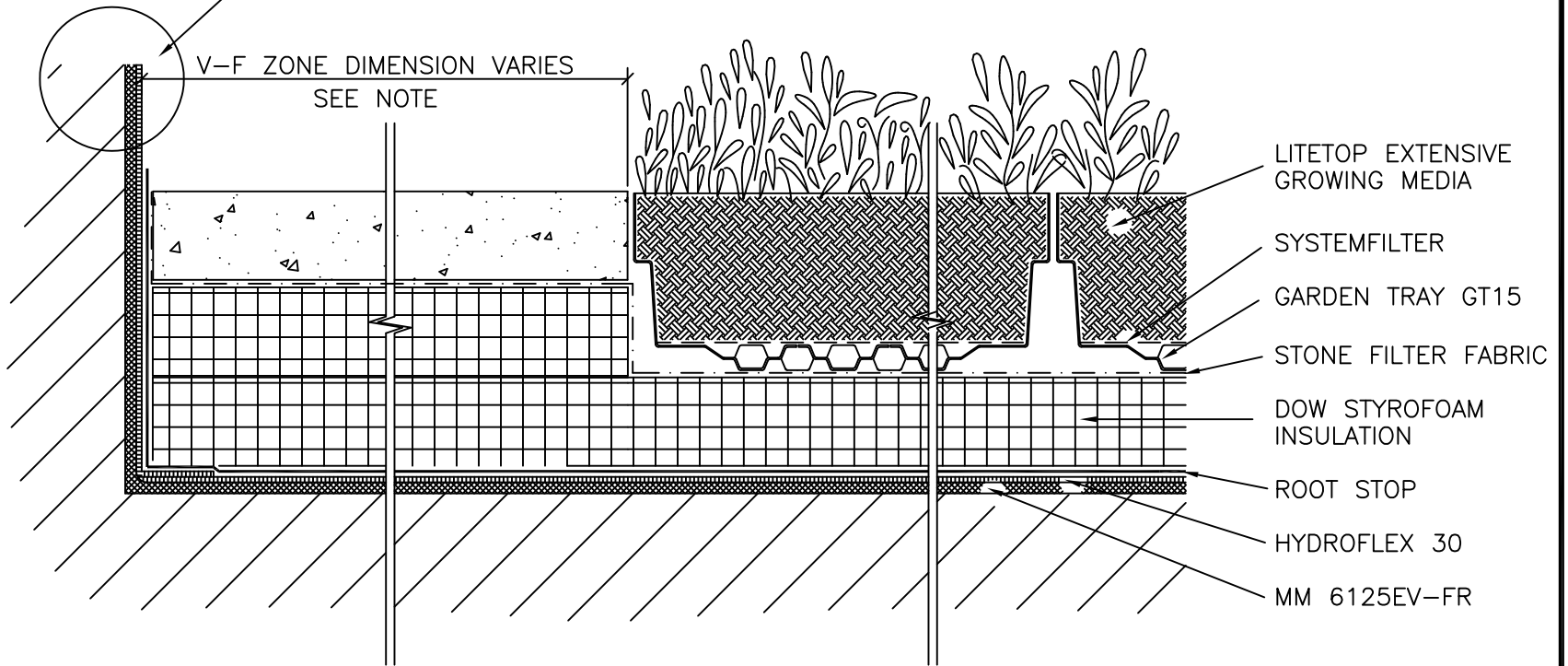

NOTES:

THE VEGETATION-FREE ZONE MAY BE COMPOSED OF TYPICAL STONE BALLAST OR CONCRETE PAVERS AND WILL BE DEPENDENT ON BALLAST DESIGN REQUIREMENTS. CONTACT HYDROTECH FOR ANALYSIS IN ACCORDANCE WITH DOW BALLAST DESIGN GUIDE - TECHNNOTE 508.

ADDITIONAL LAYER(S) OF INSULATION UNDER PERIMETER BALLAST, AS DEPICTED, MAY BE OMITTED PROVIDED ALTERNATIVE TRAY RETENTION IS INSTALLED.

ROOT STOP IS LOOSE LAID OVER THE HYDROFLEX 30 AND LAPPED A MINIMUM OF 5' OR 1' WITH LAPS TAPED.

REFER TO DETAILS GR-2A AND 2B FOR ADDITIONAL EXTENSIVE GARDEN ROOF ASSEMBLY BUILD UP OPTIONS.